

# Shaping the Future in Extruded Products

**For World-Class Quality, Service and Engineering,  
Turn to Sapa Profiles, Inc.**

**Sapa Profiles, Inc.** is part of the world's largest aluminum profile company. Throughout North America, we are a prominent supplier of extruded aluminum products to the **Building & Construction, Commercial Transportation, Automotive, Industrial & Consumer, and Distribution markets.**

Our expanded operations open a universe of opportunities for our customers:

- The industry's broadest product capabilities... in alloy selection, circle sizes (up to 12") finishing and fabrication services
- More efficient logistical solutions - plants located in Portland, Oregon supported by 7 additional Sapa plants and able to deliver anywhere in North America
- Enormous competencies for design assistance and technical support
- Certified to ISO 9001:2000
- In-house die making facilities

**We offer high value-added products driven by a comprehensive understanding of our customer's business. Sapa strives to establish close and long-term customer relationships, often in the form of partnerships.**

## Unmatched Choice in Soft Alloy Aluminum Extrusions

Sapa offers decades of experience in a complete range of standard and custom shapes. Our engineering, manufacturing, design and marketing specialists can assist with custom solutions for your unique applications. We employ the latest technology for the design and manufacture of extrusion tooling, including CAD/CAM design. We have engineers and metallurgists to provide **everything you need to go from idea to finished product.**

## The Industry's Most Comprehensive Product Line



- Standard and Custom Extruded Shapes (Solid, Semi-Hollow and Hollows) with wall thickness down to .045"
- Structural Pipe and Tube
- Standard Rod, Bar, Angle, Channel, and I-beams

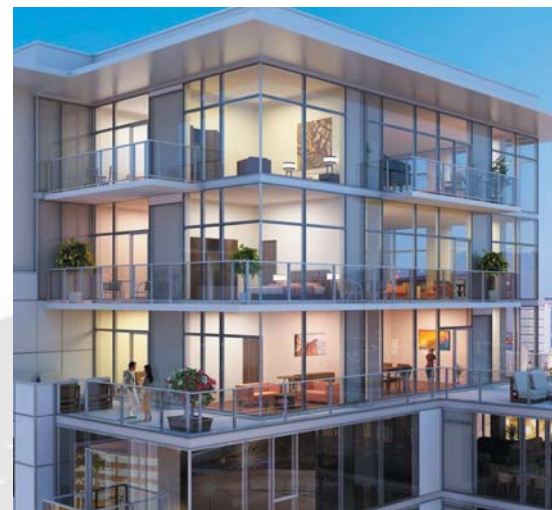
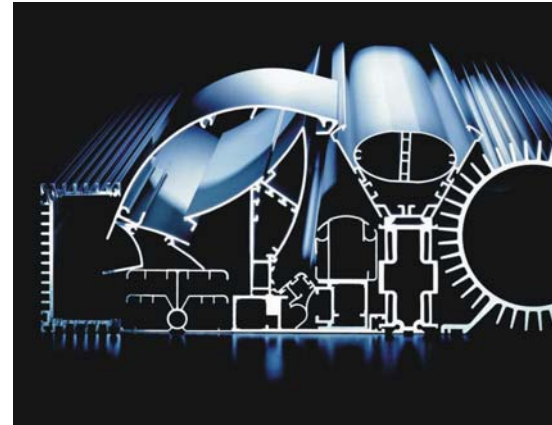

## Fabricating Services - Semi-Finished and Fully Finished Components and Assemblies

Extensive facilities for fabrication are integrated with our extrusion operations, **enabling customers to sequence 100% usable net weight parts directly into a production line.** We offer complete capabilities in:

- CNC Machining Centers
- Precision cutting, punching, bending, forming, deburring, beveling/chamfering and welding
- Painting/Anodizing
- Project Management/Engineering and Design

## Manufacturing Flexibility... an Extraordinary Range of Press Sizes and Capabilities, Including North America's Largest Selection of Both Direct and Indirect Extrusion Presses

Plant Location	Press Tonnage	Maximum Circle Size
Oregon, Portland	550 to 3,000 Ton	Up to 12"

### Supported by these Additional Sapa Locations:

Arkansas (Magnolia)	1,550 to 3,000 Ton	Up to 11"
Illinois (Morris)	3,600 to 7,300 Ton	Up to 22"
Kansas (Parsons)	1,650 Ton	Up to 7"
Louisiana (Delhi)	1,800 to 3,000 Ton	Up to 10"
Pennsylvania (Cressona)	1,500 to 6,000 Ton	Up to 19"
South Dakota (Yankton)	1,800 to 3,500 Ton	Up to 14"
Utah (Spanish Fork)	3,000 to 4,250 Ton	Up to 12"

## Contact Us

**Sapa Profiles, Inc. is committed to providing the most responsive customer service in the industry.**

A company that is easy to do business with, we offer the industry's top professionals with unprecedented resources for innovative product and service solutions.

## GENESIS

Through our Genesis operating system, we are dedicated to a process of continuous improvement throughout our organization. It is the way we add value at every stage to become a better partner for our customers.

**Contact us by phone, fax or email for information, quotes and world-class support...and watch your solutions take shape.**

### Sapa Profiles, Inc.

7933 NE 21st Avenue  
 Portland, OR 97211  
 Phone: 503-802-3000  
 800-547-0790 (Toll-Free)  
 FAX: 503-802-3052  
[www.sapagroup.com/us/profiles](http://www.sapagroup.com/us/profiles)



Sapa is a proud member of the U.S. Green Building Council®.

**sapa:**  
 Shaping the future